

# DHI-LPH65/75/86/98-MC470-P

65/75/86/98" DeepHub Pro Smart Interactive Whiteboard



- Equipped with Zero Air Gap technology, the 65, 75 and 86 inch 4K DLED display delivers clear images in sharp and vivid colors. The 98-inch display uses full lamination technology.
- Built-in AI 4K camera and 8 array microphone that produces excellent quality visual and audio communication.
- Wireless screen sharing from multiple devices with an intuitive, easy-to-use system.
- Ultra-smooth writing experience with handwriting recognition.
- Quick file sharing by scanning a QR code, with easy file encryption for added privacy and security.
- Optional OPS module, dual-system switchable.
- Fingerprint lock for protection of user information.

## System Overview

Dahua DeepHub Pro Smart Interactive Whiteboard is a new generation of smart interactive whiteboards that have a high performance main controller and multiple intelligent functions. It adopts direct-type LED backlight technology and has a 4K LED display that is built of anti-dazzle tempered glass with a hardness of 7 on the Mohs scale. The display comes in 65", 75", 86" and 98". This ultra-thin whiteboard supports up to 20 multi-user writing points and is equipped with a 48 MP motorized lens, speakers, 8 microphone arrays, and is touchscreen. It offers various functions such as video conferencing, writing on the whiteboard, wireless screen sharing and allows you to scan codes to access content on the whiteboard.

## Functions

### 4K Camera with Ultra-wide FOV

8-MP with a maximum resolution of 4K@30 fps. It supports live videos and has an ultra-wide field of view (diagonal 99°, horizontal 87°, and vertical 49°), displaying vivid images even when placed in relatively large meeting rooms.

### AI Recognition of Drawings

Identifies hand-drawn structures such as straight lines, dotted lines, arrow-straight lines, arrow-dotted lines, triangles, parallelograms, trapezoids, rectangles, circles, pentagons, cylinders, pentagrams, semicircles, and rounded rectangles.

### Easy to Share

Enhances the experience of sharing files by scanning a code. It automatically determines the network of the device to readily share the QR code across the extranet and the intranet. QR code encryption and extraction are also featured, providing privacy and data security through the required entry of a 6-digit password for verification.

### Non-contact Motion-controlled System

Recognizes various types of body movements, such as grabbing, up, down, left and right motions, to interact with elements on the screen without touching the screen. You can motion to turn pages, scroll in different directions in a document, and take screenshots.

### Screen Sharing

The content on your screen can be freely shared with one other device through a wired connection.

### Similar to Real Writing Experience

The electronic whiteboard supports pen-point writing. It comes equipped with specialized pressure-sensitive writing pens, designed to enhance the writing experience. With its soft, comfortable nib, writing on the whiteboard feels natural, similar to the real writing experience.

### Text Recognition

Converts written letters into text in real time, using the default font of the system.

### Wireless Screen Sharing

In addition to basic file sharing, the device offers wireless screen sharing, interactive operations between two screens, and reverse transmissions. It also supports screen grouping (multiple transmission), host mode (for overall permission control), real-time transmission of images, videos and audios from the wireless camera of the mobile phone to the device, and split-screen mode that displays up to 9 splits on the same screen.

### Strong Security System

Designed with a strong security system, the device features digital password, gesture password and fingerprint password for added protection. These unlock methods can all be applied to USB permissions, the lock screen, touch lock and the factory restore settings. Up to 100 fingerprint passwords can be set, and the false acceptance rate is less than 0.001%.

## Technical Specification

### Built-in System

CPU Frequency	2.2 GHz + 2.0 GHz
GPU	ARM Mali-G52 MP8 (8EE)
Operating System	Android 11.0
CPU	Quad-core A73 + Quad-core A53
RAM	12 GB (System: 8 GB, Camera: 4 GB)
ROM	64 GB

### Function

Operating System of External Module	Windows 7/8/10; Android
WiFi	Dual-band 2.4 G/5 G; supports 802.11 a/b/g/n/ac wireless frequency range
Wi-Fi Hotspot	Dual-band 2.4 G/5 G; supports enabling Hotspot and Wi-Fi at the same time

### LCD Panel

Response Time	8ms (typ.)
Panel Dimensions	65-inch; 75-inch; 86-inch; 98-inch
Backlight	DLED
Aspect Ratio	16:9
Brightness	65-inch: 350 cd/m <sup>2</sup> ; 75-inch: 350 cd/m <sup>2</sup> ; 86-inch: 400 cd/m <sup>2</sup> ; 98-inch: 400 cd/m <sup>2</sup>
Resolution	3840 (H) × 2160 (V)
Viewing Angle	H: 178°; V: 178°
Lifespan	50,000 h
Display Color	1.07 B/10 bit (8 bit + FRC)
Refresh Rate	60 Hz
Static Contrast	VA: 4000 (typ.); IPS: 1200 (typ.)

### Camera

Pixel	48 MP
Auto Control	Auto flip; Auto white balance
Distortion	-8.6%
Max. Resolution	3840 × 2160@30 fps
Storage	8 GB eMMC
Field of View	H: 87°; V: 49°; D: 99°
Face Detection	Yes

### Device Ports

Light Sensor	1
Front Button	1 × power button (right side)
Front Ports	1 × USB 3.0 (left side)
Network Port	1 × RJ-45
Wi-Fi	1 × Wi-Fi; 1 × Hotspot

USB	3 × USB 3.0; 1 × Micro USB
RS-232	1 × RS-232
Video Input	1 × HDMI IN
Video Output	1 × HDMI OUT
Audio Output	1 × 3.5 mm (Line OUT) port
Others	1 × Touch
IrDA	1
Microphone	8 Array
Type-C Port	1 × Type-C

### Touchscreen

Touch Technology Type	Infrared touch technology
Response Time	< 10 ms
Touch Points	Supports 20 touch points and drawing up to 20 lines
Valid Touch	2 mm
touch accuracy	± 1 mm
Writing Mode	Finger + Pen (attaches magnetically)
Anti-light Interference	Anti-dazzle tempered glass
Surface Hardness	7 on the Mohs scale
Touch Resolution	32767 × 32767
Number of Multi-user Writing Points	10

### Speaker

Frequency	150 Hz–20 kHz
Power	15 W × 3 (Max.)
Built-in Speaker	3

### Fingerprint

Fingerprint Capacity	100
Fingerprint Resolution	160 × 160
FAR	0.001%

### Microphone

Pick-up Distance	Far-field sound pickup: 6 m–8 m (19.69 ft–26.25 ft)
Number of Microphones	8
AGC	Yes
Echo Cancellation	Yes
Polar Pattern	Omnidirectional
Intelligent Noise Filtering	Yes

### General

Power Supply	100–240 VAC, 50/60 Hz
Power Consumption	65-inch: 120 W (typ.); 200 W (max.); 75-inch: 160 W (typ.); 300 W (max.); 86-inch: 160 W (typ.); 400 W (max.); 98-inch: 270 W (typ.); 600 W (max.)

Operating Temperature	0 °C to +40 °C (+32 °F to +104 °F)
Storage Temperature	-10 °C to +50 °C (+14 °F to +122 °F)
Operating Humidity	10%–90%
Storage Humidity	10%–90%
Product Material	Metal casing
Protective Glass	Anti-dazzle tempered glass with a hardness of 7 on the Mohs scale
Casing Color (Frame/Rear)	Bottom/top: Silver; left/right: black
Product Dimensions	65-inch: 1,485 mm x 967.8 mm x 93.3 mm (58.46" x 38.10" x 3.67") 75-inch: 1,707.2 mm x 1,094.47 mm x 93.3 mm (67.21" x 43.09" x 3.67") 86-inch: 1,953.2 mm x 1,232.7 mm x 93.3 mm (76.90" x 48.53" x 3.67") 98-inch: 2,216.4 mm x 1,381.7 mm x 109.6 mm (87.26" x 54.40" x 4.31")
Packaging Dimensions	carton: 65-inch: 1,587 mm x 1,055 mm x 260 mm (62.48" x 41.53" x 10.24") 75-inch: 1,810 mm x 1,150 mm x 260 mm (71.26" x 45.28" x 10.24") 86-inch: 2,055 mm x 1,325 mm x 260 mm (80.91" x 52.17" x 10.24") 98-inch: 2,337 mm x 1,470 mm x 255 mm (92.01" x 57.87" x 10.04") pallet: 65-inch: 1,620 mm x 1,060 mm x 120 mm (63.78" x 41.73" x 4.72") 75-inch: 1,830 mm x 1,060 mm x 120 mm (72.05" x 41.73" x 4.72") 86-inch: 2,100 mm x 1,060 mm x 120 mm (82.68" x 41.73" x 4.72") 98-inch: 2,340 mm x 1,040 mm x 155 mm (92.13" x 40.94" x 6.10")
Net Weight	65-inch: 40 kg (88.18 lb) 75-inch: 54 kg (119.05 lb) 86-inch: 67 kg (147.71 lb) 98-inch: 91 kg (200.62 lb)
Gross Weight	65-inch: 50 kg (110.23 lb) 75-inch: 65 kg (143.30 lb) 86-inch: 80 kg (176.37 lb) 98-inch: 107 kg (235.89 lb)
Holes Distance	65-inch: 500 mm x 400 mm (19.69" x 15.75") 75-inch: 600 mm x 400 mm (23.62" x 15.75") 86-inch: 800 mm x 400 mm (31.50" x 15.75") 98-inch: 1000 mm x 400 mm (39.37" x 15.75")
Installation	Wall mount; mobile bracket
Standby Power Consumption	≤ 0.5 W
Packing List	Smart interactive whiteboard x 1 Power cord x 3 Stylus pen x 2 Quick start guide x 1 Wall mount bracket (already installed on the whiteboard): x 1 Accessory package x 1 Remote control x 1
Certifications	ENERGY STAR (except 98-inch model); CB; CE

**Installation**

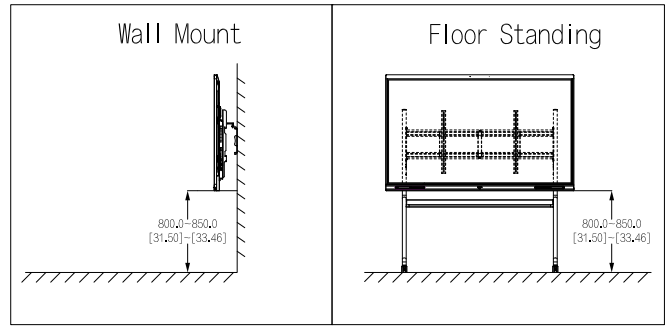

**Dimensions (mm[inch])**

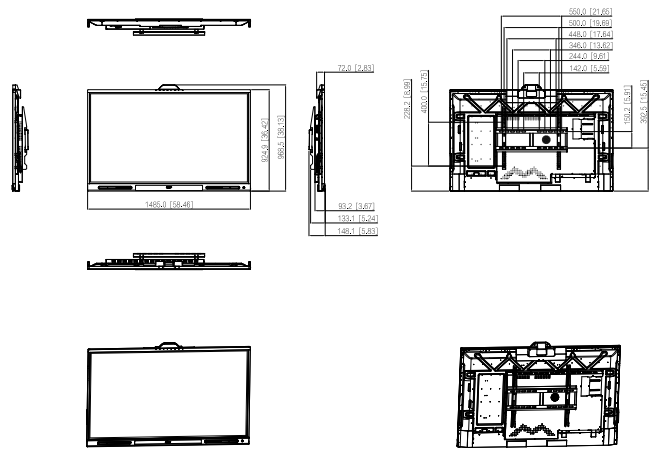

65-inch

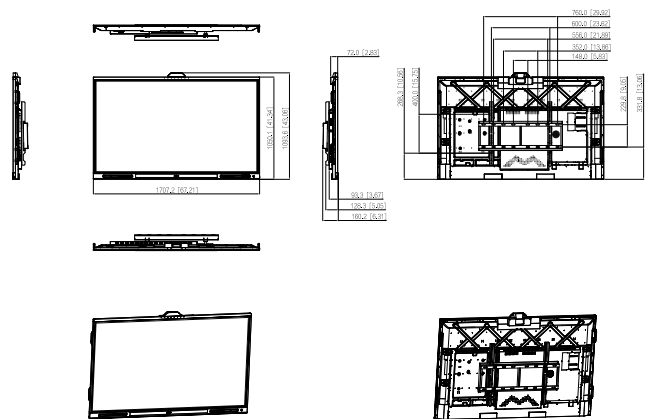

75-inch

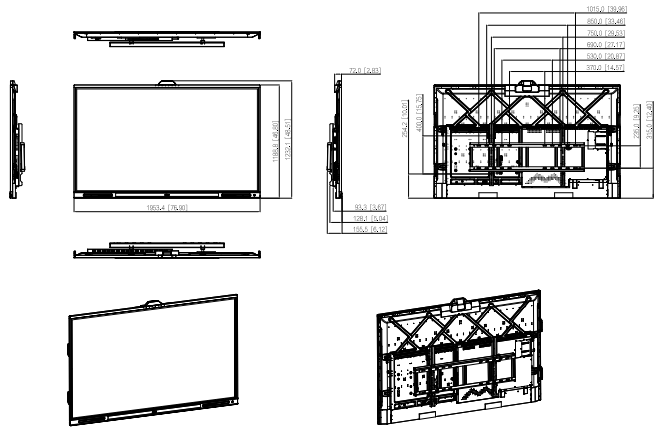

86-inch

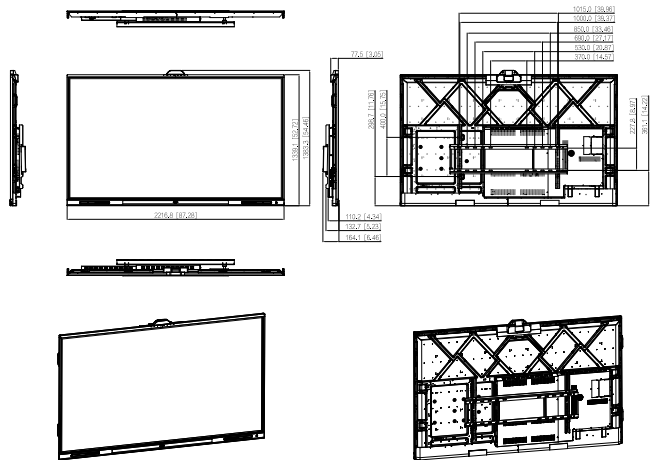

98-inch

Panels

