

Tool list

The installation tools are not provided with the AP. Prepare them yourself.

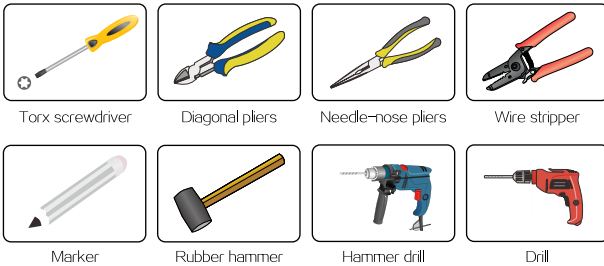

Introduction to Installation Accessories

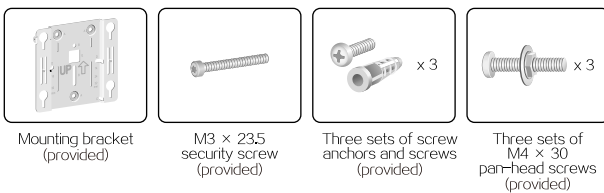

1

Device/mounting bracket dimensions

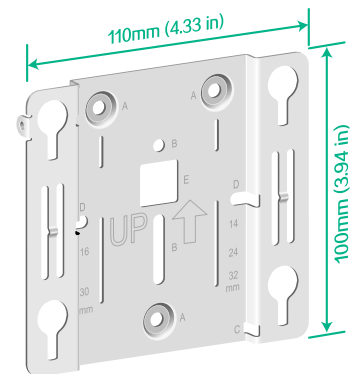
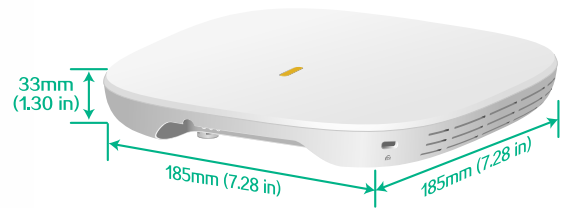

2

Mounting bracket

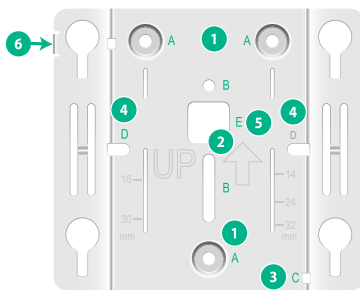

- 1 Installation hole for securing the mounting bracket to a wall or ceiling (point A)
- 2 T-rail installation hole (reserved) (point B)
- 3 Auxiliary hole for securing cables by using cable tie (point C)
- 4 Installation hole reserved for electrical outlet box installation (point D)
- 5 Auxiliary hole for threading a cable to connect to the AP (point E)
- 6 Security hole for an M3 x 23.5 security screw

Mounting the device

- As a best practice, connect cables to the device before mounting the device.
- Install the M3 x 23.5 mm security screw as needed.

3

Mounting the device on a wall

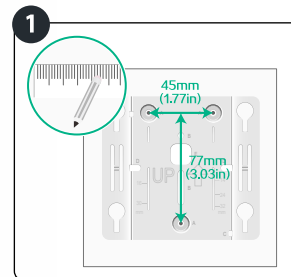

Mark installation hole locations on the wall.

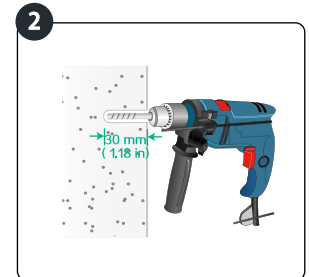

Drill three holes with a diameter of 6 mm (0.24 in) at the marked locations.

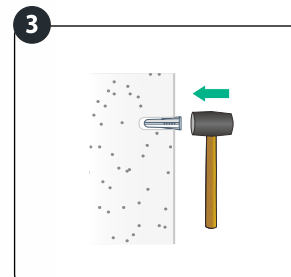

Hammer a screw anchor into each hole.

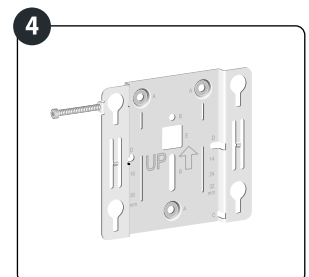

Install the M3 x 23.5 mm security screw to the mounting bracket. Make sure the screw does not block the keyhole slot.

4

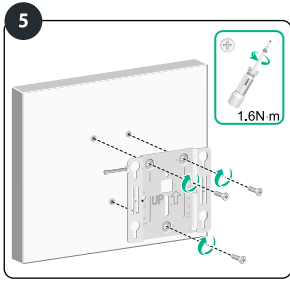

Use screws to attach the mounting bracket to the wall.

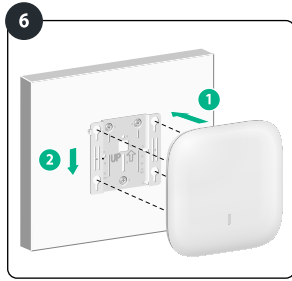

Align the pegs at the device rear with the keyhole slots on the mounting bracket, and rest the device on the bracket. Then, slide down the device until it clicks into place.

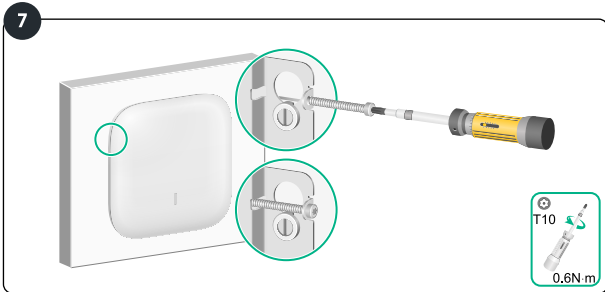

Use the Torx screwdriver to fasten the M3 × 2.35 mm security screw.

5

Mounting the device on the ceiling

A The installation method of the M3 × 2.35 mm security screw is the same for wall mounting and ceiling mounting.



1 Remove the ceiling tile and mark installation holes. Drill three holes in the ceiling tile.

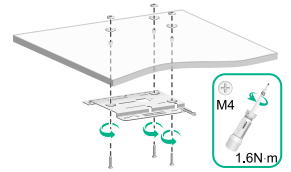

2 Use the pan-head screws to attach the mounting bracket to the ceiling tile.

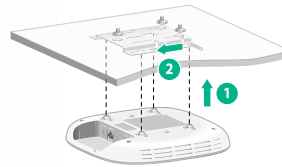

3 Align the pegs at the device rear with the keyhole slots on the mounting bracket, and attach the device to the bracket. Then, slide the device horizontally until it clicks into place.

(Optional) Securing device cables for ceiling mounting

- No cable tie is provided with the device. Prepare one yourself.
- Before mounting the device to the installation bracket, drill a hole in the ceiling tile. To secure the device cable for ceiling mounting, perform the following steps:
 - 1) Feed a cable tie through the slot on the mounting bracket, making sure the cable tie is loosely applied to allow the tie to slide around the cable.
 - 2) Connect one end of the cable to the device, adjust the cable length, insert the other end through the hole in the ceiling tile, and then tighten the cable tie.
 - 3) Secure the device to the installation bracket.

6

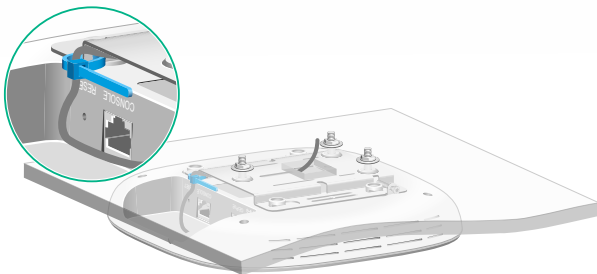

Connecting a power adapter

A No power adapter is provided with the device. Order it yourself.



7

Power adapter specifications:

Item	Specification
Input	100 – 240V AC
Output	+48 ~ 54V DC \ominus \oplus
Output power	≥15W

Connecting an Ethernet cable

