

# B

1

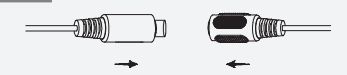

2

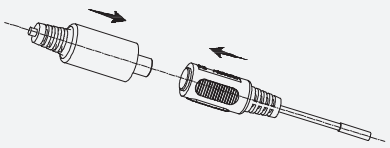

3

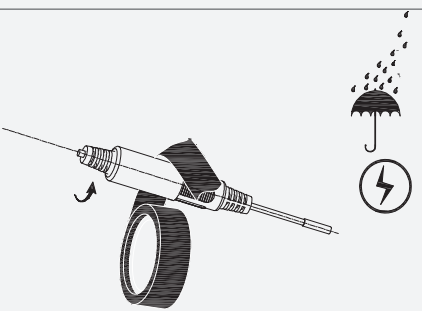

4

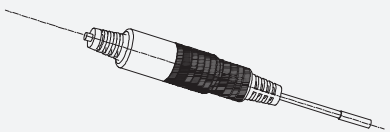

3.1

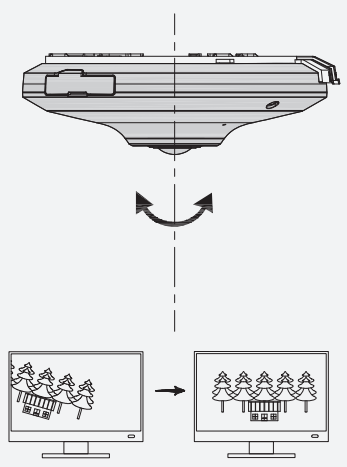

4.1

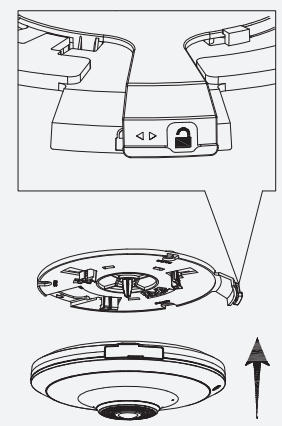

4.2

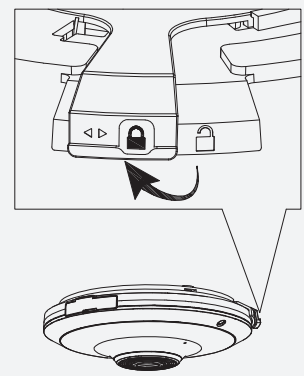

# Fisheye Network Camera

Installation Guide

V1.0.0

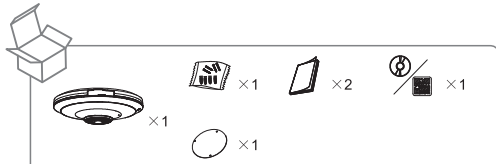

## 1.1

Optional

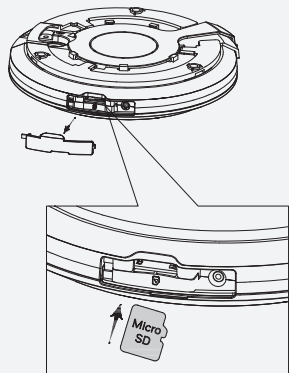

Shopping cart icon, Power drill icon, Screwdriver icon

### 2.1.1

Step 2.1.1: A hand is shown connecting the camera to the ceiling plate.

### 2.1.2

Step 2.1.2: A power drill is used to drill a hole in the ceiling plate. A callout shows a hole with a diameter of 5mm (φ5mm).

### 2.1.3

Step 2.1.3: Two screws are shown being inserted into the ceiling plate.

### 2.1.4

Step 2.1.4: The camera is shown with cables connected to it. A callout shows a PH1 screwdriver. Labels A and B indicate cable connections.

Warning icon: A warning triangle with an exclamation mark and a crossed-out power symbol, indicating that power should be disconnected during this step.

### 2.2.1

Step 2.2.1: A hand is shown mounting the camera to the ceiling plate.

### 2.2.2

Step 2.2.2: A power drill is used to tighten the screws.

### 2.2.3

Step 2.2.3: The camera is shown fully mounted to the ceiling plate.

### 2.2.4

Step 2.2.4: The camera is shown with cables connected to it. Labels A and B indicate cable connections.

## A

### 1

Step 1: A hand is shown connecting the camera to the ceiling plate.

### 2

Step 2: A hand is shown connecting the camera to the ceiling plate.